

## Shower Wall Liner Installation Instructions

### Before Installation please check that your wall is undamaged

- Check to ensure the shower tray has been installed in accordance with Athena Tray Installation Instructions. The tray must be level to achieve optimum results
- Your Athena Shower has been designed for walls lined with new 10mm Gib board or equivalent wallboards and Villa Board. **Ensure that area that will be covered by the Wall liner is not Gib stopped, sanded, sealed or painted – The Showerbond adhesive will not adhere to these surfaces**
- Only use the Showerbond adhesive supplied, failure to do so will void your warranty
- Ensure that any plumbing outlets are situated as not to obstruct the door when opened. (The trailing edge of Pivot doors swing into the shower area)

### INSTALLATION

1. Carefully measure and cut out the wall liner for tap-ware. (refer to cutting and drilling instructions on next page)
2. Trial fit the wall lining by offering it into the rear corner of tray. When correctly fitted the vertical edge of the liner will sit slightly back from the front edge of the tray. The liner must not protrude the front edge of the shower tray as this will affect the door installation.  
If the tray is installed level and the walls are plumb the liner should sit hard down to the tray surface. If the wall liner does not sit flat to the tray it can be scribed and trimmed using a hand plane or sandpaper  
**Caution: Trimming the Wall liner may will reduce its height, some discretion will be required to determine the amount of trimming possible**
3. Using a pencil to mark a line around the perimeter of the wall lining.
4. Ensure wallboard and rear of wall liner are free from dirt, dust and any contaminants.
5. Apply a continuous bead of NG silicone sealant 10mm in diameter along the inside edge of the Tray Upstand. Apply the sealant to the top half of the upstand to eliminate it squeezing out under liner when fitted.
6. 20mm in from the edge of the tray apply a vertical bead of NG silicone sealant the full height of the Tray upstand.
7. Using the supplied Shower Bond adhesive apply in vertical lines at 100mm spacing, staying 10mm in from the marked outline of the wall liner.  
**Installation of liner must be complete within 15 min to avoid premature curing of adhesive.**

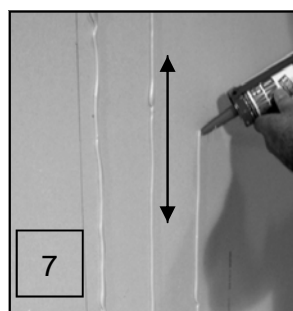
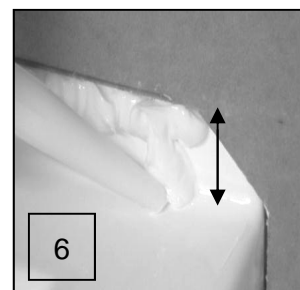
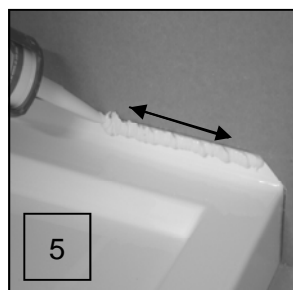
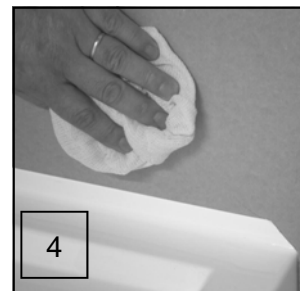
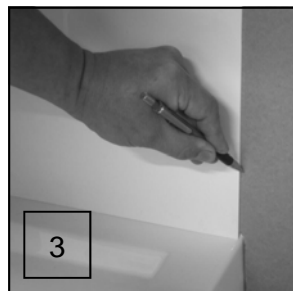
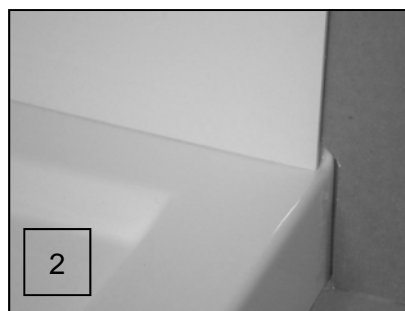

## INSTALLATION CONTINUED

8. Place wall lining into position and press firmly onto adhesive over entire surface. Wipe off any excess sealant or adhesive that may have oozed out
9. Peel off protective film from lining and fit tap-ware.  
**DO NOT remove the tray's protective masking yet.**
10. Seal the top edge of the wall liner with Selley's "No More Gaps" or a similar sealant.
11. The installation of the enclosure may begin immediately or as required.

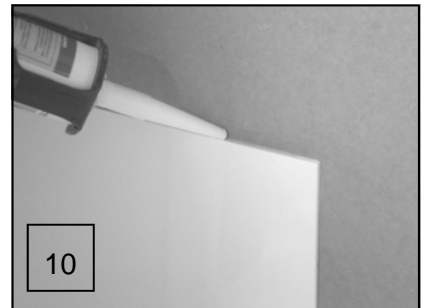
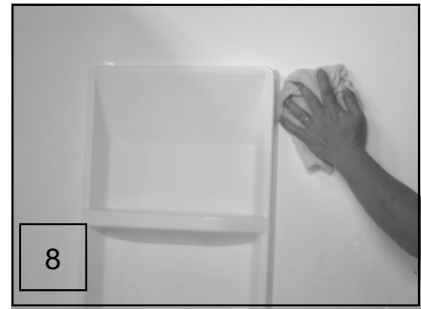

## CUTTING AND DRILLING

- Hacksaw or Jigsaw with a minimum of 18 teeth per inch.
- Holes up to 12mm in diameter can be drilled with standard twist drill with a reduced cutting angle.
- Holes larger than 12mm diameter can be cut using a hole saw.
- Edges can be finished with medium grit sandpaper or planed with a hand plane.



**WHEN CUTTING INTERNAL CORNERS DO NOT CUT SQUARE,  
ALWAYS ENSURE THEY HAVE A RADIUS**